

## Eco Preparation 1800 mm Passthrough Hot Cupboard

ITEM # \_\_\_\_\_

MODEL # \_\_\_\_\_

NAME # \_\_\_\_\_

SIS # \_\_\_\_\_

AIA # \_\_\_\_\_

**132884 (MSRP1807N)**Hot pass-through cupboard,  
1800mm

### Short Form Specification

#### Item No.

Made entirely from stainless steel. Inner welded frame in stainless steel. Unique connection of panels to inner frame. Worktop in 304 AISI stainless steel (40mm high) incorporates a layer of sound deadening material and has upturned edges. Sound-deadened sliding doors. Handles are formed by a fold in the sliding doors. Height-adjustable intermediate shelf with riveted corners and transversal reinforcement in stainless steel. Ventilated hot air flow system guarantees temperature evenness, air flows underneath the intermediate shelf and throughout the cabinet. Thermostat with digital display to adjust the internal temperature (from 50°C to 70°C). Mounted on feet, adjustable in height.

### Main Features

- Digital display thermostat to control the internal temperature.
- Ideal for central positioning in the kitchen, either as island installation or back to back.
- Handles in stainless steel for better hygiene and reliability.
- Model specific to keep dishes warm.
- Sturdiness, stability and reliability of table accurately tested.

### Construction

- 40 mm worktop in 304 AISI stainless steel.
- Inner welded frame in stainless steel to guarantee superior strength and stability.
- Handles directly built into the sliding doors.
- Equipped with intermediate shelf which can be positioned at three different heights.
- Intermediate shelf in stainless steel with riveted corners and transversal reinforcement in stainless steel.
- Sturdy sound-deadened sliding doors on tracks located flush to the front of the frame.
- Easy access to the cupboard interior on all lengths guaranteed by the use of only 2 doors.
- Constructed entirely in stainless steel to offer maximum durability.
- Constructed entirely in stainless steel to offer maximum durability.
- Base panel has 40mm high profile, is 8/10 in thickness with upturned edges and bar reinforcement. It is welded to legs for further structure reinforcement.
- 304 AISI stainless steel feet, 150 mm high and 54 mm in diameter, adjustable by -35/+25 mm.

### Optional Accessories

- Overshelf, neutral, one tier, PNC 132968 □  
1800 mm
- Overshelf, with led light and PNC 132992 □  
ceramic light, one tier, 1800mm
- Wheel kit for cupboards, 4 PNC 855299 □  
wheels (2 with brakes), D=1000  
mm

**APPROVAL:** \_\_\_\_\_

# Eco Preparation 1800 mm Passthrough Hot Cupboard

**Front**

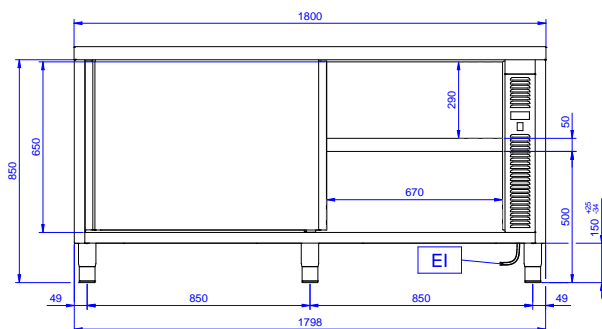

**Side**

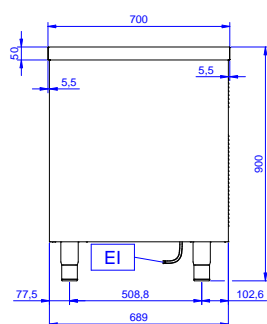

**EI** = Electrical inlet (power)

**Top**

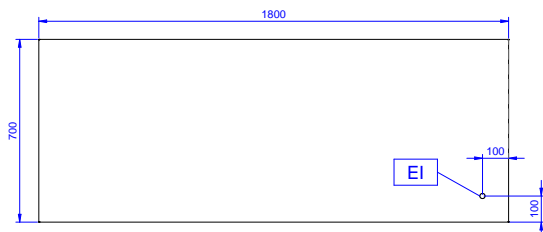

## Electric

**Supply voltage:** 220-240 V/1N ph/50/60 Hz  
**Total Watts:** 2.4 kW

## Key Information:

**Cabinet width:** 1630 mm  
**Cabinet depth:** 604 mm  
**Cabinet height:** 610 mm  
**Cabinet temperature:** 50-70 °C  
**External dimensions, Width:** 1800 mm  
**External dimensions, Depth:** 700 mm  
**External dimensions, Height:** 900 mm  
**Worktop thickness:** 50 mm  
**Net weight:** 70 kg